

## Angular Contact Ball Bearings

### Brass cage angular contact ball bearing-7219 BECBM

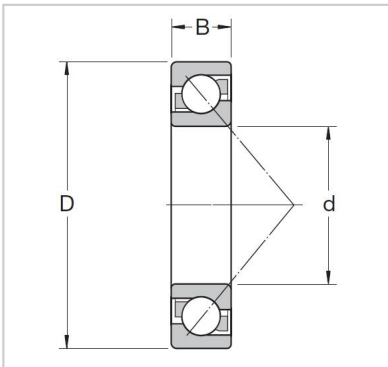

#### Abutment and fillet dimensions

Db max.	<b>7219 BECBM</b>
Da max.	-
da min.	95
rb max.	170
ra max.	32

#### Dimensions

a	124
r3,4 min.	108
r1,2 min	4
D1	4 300
d2	4 500
d1	2.7

#### Mass

KG	124
----	-----

#### Speed ratings r/min

Limiting speed	109
Reference speed	143

#### Fatigue load limit

Pu kN	2.1
-------	-----

#### Basic load ratings KN

dynamic C kN	1.1
static Co kN	<b>72</b>

#### Basic design bearing

B mm	107
D mm	158
d mm	163

#### Basic design bearing

Designations	
Universally matchable bearing	<b>1</b>